

# Fast Track Guide

## Nikon

### COOLPIX 880

This *Fast Track Guide* takes you through the steps involved in setting up your camera and using it in AUTO mode, a “point-and-shoot” mode that will produce the desired results in most situations. If you are new to digital photography, refer to the “Tutorial” section in the *Guide to Digital Photography* for complete information on getting started with your COOLPIX 880. Cross-references to other documentation are marked by the following symbols:

- Guide to Digital Photography*
- For Your Safety*

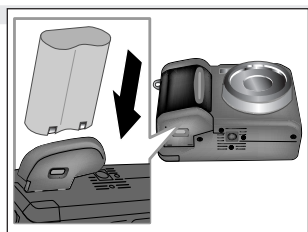

#### 1 Insert the battery

Be sure the camera is off before inserting or removing the battery.

The battery chamber is located in the bottom of the handgrip. Press the latch and open the cover. Insert a six-volt, 2CR5 (DL245) lithium battery (provided) or a Nikon EN-EL1 rechargeable Li-ion battery (available separately) as shown above, then close the cover and confirm that it is properly latched.

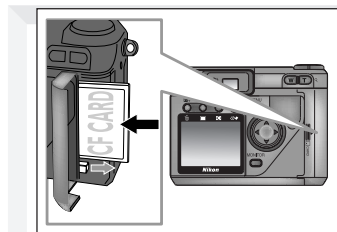

#### 2 Insert the memory card

Turn the camera off before inserting or removing memory cards.

Open the card-slot cover and slide the memory card in as shown above, then close the cover.

Before first use, the memory card must be formatted using the **CF Card Format** option in the SET-UP menu (see Step 3).

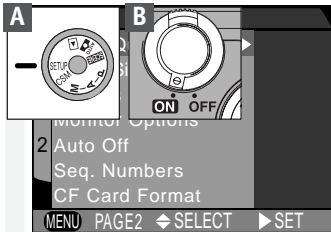

#### 3 Set up the camera for use

After removing the lens cap, turn the mode dial to SETUP (A) and then turn the camera on (B). Before using the camera for the first time, use the options in the SET-UP menu to:

Action	Option	Page
Format card	CF Card Format	19
Pick language	Language	20
Set date	Date	21



#### 4 Adjust image quality

Together with image size, image quality determines the number of photos that can be stored on the memory card. Image quality for AUTO and SCENE modes is chosen from the IMAGE QUALITY sub-menu, which is accessed from the first page of the SET-UP menu. The following options are available:

Image Quality	Description
HI	Fewer images, higher quality
FINE	More images, basic quality
NORMAL	
BASIC	

**Note:** A setting of **HI** only takes effect when the mode dial is set to P, A, M, or CSM. In AUTO and SCENE modes, **HI** is equivalent to **FINE**.

**Note:** The SET-UP menu has two pages of options. To go from one page to the other, press the MENU button. Use the multi selector to highlight options and make selections.



### Where to Find It: Camera Controls

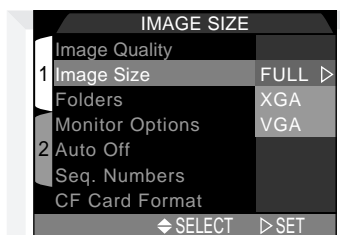
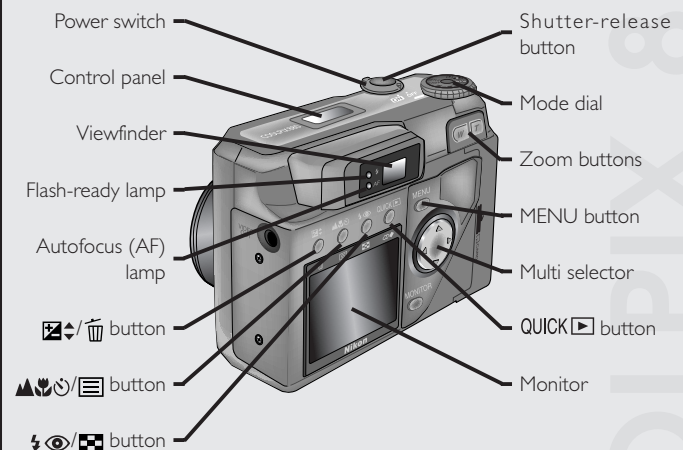

#### 5 Choose an image size

Image size for AUTO and SCENE modes is chosen from the IMAGE SIZE sub-menu in the first page of the SET-UP menu. The following options are available:

<b>FULL</b>	2048 × 1536 pixels
<b>XGA</b>	1024 × 768 pixels
<b>VGA</b>	640 × 480 pixels

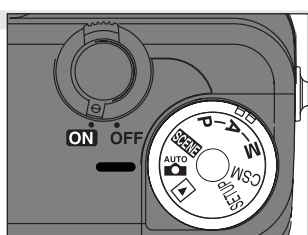

#### 6 Select AUTO mode

Turn the mode dial to AUTO. AUTO mode is a simple, “point-and-shoot” mode in which you control focus mode and flash settings. The camera adjusts other settings automatically for the best results.

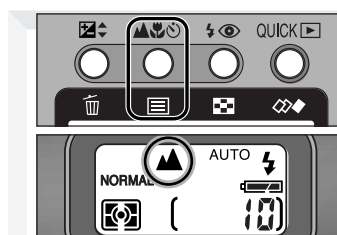

#### 7 Check the focus mode

By default, the camera adjusts focus automatically for subjects 40 cm (16”) or more from the lens. To choose another focus setting, press the button. The following settings are available:

**Autofocus** (default)

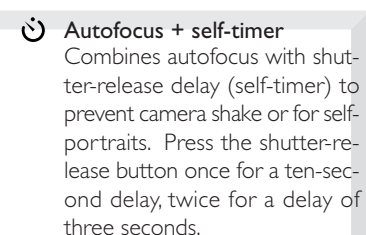

#### 8 Check the flash setting

By default, the flash fires automatically when lighting is poor. To choose another setting, press the button. The following options are available:

- Auto** (default)  
Flash fires when needed.
- Flash Cancel** (off)  
Use when subject is outside the range of the flash or to capture natural lighting under dim light.

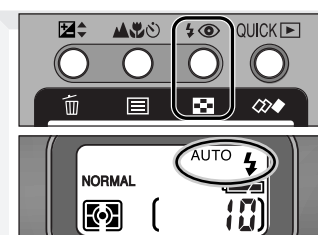

#### 9 Compose a photograph

Use the zoom buttons to frame a photograph in the viewfinder or monitor. The button zooms the camera out, reducing magnification and increasing the field of view (A). The button zooms the camera in (B). If the monitor is on or the camera is connected to a television set, you can hold the button down for two seconds at maximum zoom to enter digital-zoom mode (C), where you can zoom in a further 4.0 ×.

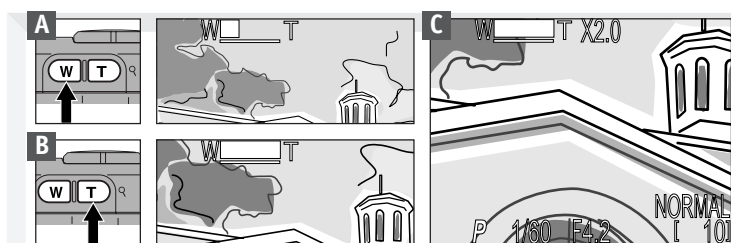

#### 10 Check focus and flash

Gently depress the shutter-release button halfway and check the autofocus and flash indicators next to the viewfinder. The camera is ready to take a picture when the autofocus lamp (green) glows steadily and the flash lamp (red) is not flashing.

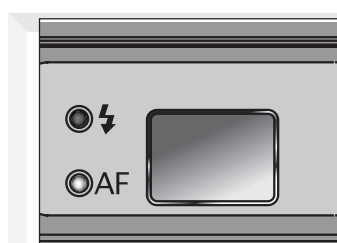

#### 11 Take a picture

To take a photograph, press the shutter-release button all the way down.



#### 12 Check the results

The photograph will be displayed briefly in the monitor while the camera transfers it to memory. To pause the display for twenty seconds, press the button. If you are not satisfied with the results, press the button to delete the photo before returning to shooting mode. To record the photograph and return to shooting mode immediately, press the shutter-release button halfway.

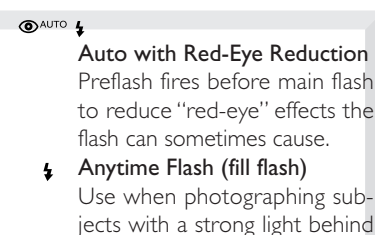

#### How Many Images?

The approximate number of images that can be recorded on 8 MB and 16 MB memory cards at different combinations of image quality and size is shown in the following chart:

8MB Card	FULL	XGA	VGA
HI	0	—	—
FINE	5	19	48
NORMAL	10	38	91
BASIC	19	73	161

16MB Card	FULL	XGA	VGA
HI	1	—	—
FINE	10	40	100
NORMAL	20	79	187
BASIC	40	151	333

### Quick Review

Photographs stored on the memory card can be reviewed using the button. Pressing the button once displays the most recent photograph in the current folder at the top left corner of the monitor. The following operations can be performed while the image is displayed:



Button	Operation	Function
	Press	View other images in current folder
Shutter release	Press halfway	Return to shooting mode and focus
Shutter release	Full press	Return to shooting mode and shoot
	Press	Display current photograph full screen

All other camera controls function normally.

The following operations can be performed while an image is displayed full screen:

Button	Operation	Function
	Press	View other images in current folder
	Press	Zoom in on current photo (use multi selector to scroll)
	Press	Cancel zoom
	Press	Select current photo for deletion
	Press	Display menu of nine thumbnail images. Thumbnails can be highlighted with multi selector or selected for deletion by pressing  button. Press  button to view four thumbnails, press again to view highlighted image full size.
	Press	Display additional photo information
	Press	Return to shooting mode